

Contents in this document may change without prior notice.
Please obtain the delivery specification for the final design.



12.1" Wide (WXGA)

Resistive Touchscreen Module with LCD

Simple Set Plus

TK-S Series

Model: TK-SRA121WX-01A3

Product Specification

DMC Co., Ltd.

<https://www.dush.co.jp/english/>

Table of Contents

1	Summary	3
2	Product Model	3
3	Components	3
4	Packaging Specification	4
4-1	Grouped Packaging	4
4-2	Individual Packaging	6
5	Module Specification	7
5-1	Function	7
5-2	Environment	8
5-3	Mechanical Specification	8
5-4	Touchscreen Controller	8
5-5	Touchscreen Driver	8
5-6	HDMI Board	9
5-6-1	Model	9
5-6-2	External Dimension	9
5-6-3	Support Timing	10
5-6-4	Part Names (HDMI Board).....	11
5-6-5	Image Input (HDMI) I/F	12
5-6-6	Touchscreen Control USB I/F.....	12
5-6-7	12VDC Power Input I/F	13
5-6-8	LCD Backlight Control I/F.....	13
5-6-9	Touchscreen Controller Connection I/F.....	14
5-6-10	LCD(LVDS) Output I/F	14
5-6-11	Pilot Lamp LED Control I/F.....	15
5-6-12	Pilot Lamp LED	15
5-6-13	OSD Operation I/F	16
5-6-14	OSD Operation Switch Reference Circuit.....	16
6	Product Label	17
7	Compliant Standards	17
7-1	RoHS.....	17
8	Appearance inspection standard.....	17
9	Connecting Method	18
9-1	Connecting Diagram	18
9-2	Connecting Image Cable to LCD	18
9-3	Connecting Touchscreen FPC to Touchscreen Controller.....	19
9-4	Connecting Image Cable to HDMI Board.....	19
9-5	Connecting Board-to-Board USB Cable to HDMI Board.....	20
9-6	Connecting Board-to-Board USB Cable to Touchscreen Controller.....	20
9-7	Connecting Each Cable to User I/F of HDMI Board.....	21
10	Touchscreen Calibration	22
10-1	Resistive Touchscreen	22
10-2	Gesture Correction (DO NOT PERFORM)	23
11	OSD Function	24

11-1	OSD Menu	24
11-2	OSD Menu Operation	25
11-2-1	System Configuration	25
11-2-2	Adjusting Brightness	26
11-2-3	Changing Color Temperature.....	26
11-2-4	Setting Auto Close Time (Menu Time) of OSD Menu.....	26
11-2-5	Return to Initial Values.....	26
12	Terms of Use	27
12-1	Installing Resistive Touchscreen	27
12-2	Installing Module	28
12-3	Precautions for Use of LCD	28
12-4	Precautions for Resistive Touchscreen.....	28
12-5	Precautions for Static Electricity	29
12-6	Operating Precautions	29
12-7	Storing Precautions	29
12-8	Handling Precautions	29
13	Warranty	30
14	Production Discontinuance	30
15	Other	31

Appendix

- Outline Drawing (SM3-002393-10)
- Appearance inspection standard
(LCD Modules with Resistive Touchscreen) (22G4GX-00001E)

Downloads : <https://www.dush.co.jp/english/download/>

- Resistive Touch Screen Mounting Guidance (LST-series)
- Touch Screen Controller Specification: TSC-52/U User's Guide

1 Summary

This is a “TK series Simple Set Plus” with 12.1" Wide resistive touchscreen sensor, controller, and LCD(Liquid Crystal Display) plus HDMI Board.

2 Product Model

Model	Specification		
	LCD size (Resolution)	Touchscreen Type	Set Type
TK-SRA121WX-01A3	12.1" Wide (WXGA)	Resistive	Simple Set Plus

3 Components

Components	Name	Specification	Manufacturer	Model
TS+LCD	Touchscreen (TS)	Resistive	DMC	LST-121WB080A
	LCD	12.1" Wide	INNOLUX	G121ICE-L02
Accessories	Touchscreen controller	-	DMC	TSC-52/U
	HDMI board	HDMI input	DMC	SWAD-A3
	Image cable (L: 200mm)	-	DMC	23E3E4-10003
	Board-to-Board USB cable (L: 60mm)	-	DMC	23E3E4-00005

4 Packaging Specification

Depending on the number of shipments, individual packaging may be used instead of grouped packaging.

4-1 Grouped Packaging

Box	Contents	Specification	Size (W x D x H)
A	TS+LCD	Grouped packaging (20units/box)**	External dimension: 420×340×290
B	Accessories	Grouped packaging (10pcs/box)**	External dimension: 457×295×151

**May not be as specified according to the quantity shipped.

• Grouped Packaging Configuration (A)

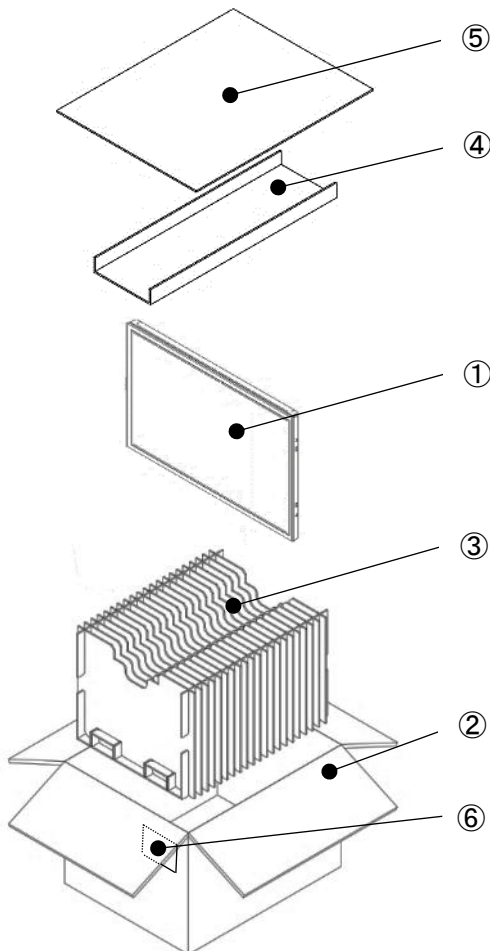

No.	Name	Qty	
①	TS+LCD (placed inside antistatic bag) ※Touchscreen with protective sheet	20	
②	Outer Box	1	
③	Partition Set	Partition 1	21
		Partition 2	2
		Bottom Supporter	2
		Frame Divider	1
④	Top Supporter	1	
⑤	Top Pad	1	
⑥	Grouped packaging label	1	

• Grouped Packaging Configuration (B)

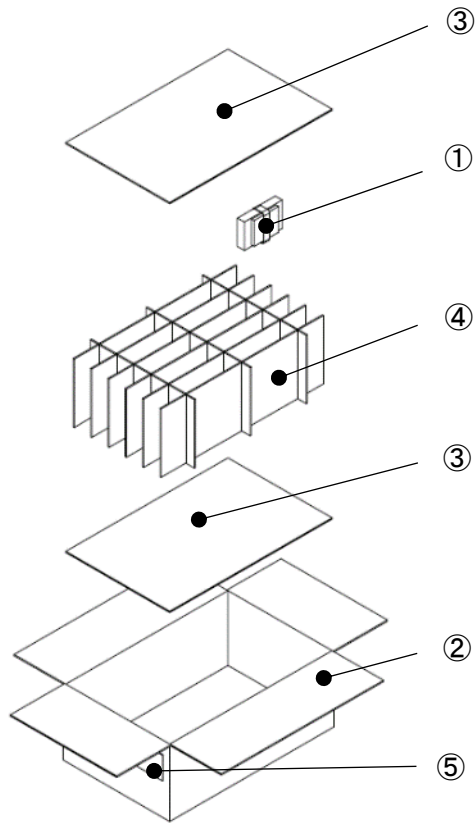

No.	Name	Qty	
①	SWAD-A3 (placed inside air-cushion bag)	10	
	TSC-52/U (placed inside antistatic bag)		
	23E3E4-10003 (placed inside antistatic bag)		
	23E3E4-00005 (placed inside antistatic bag)		
②	Outer box	1	
③	Top/Bottom pad	2	
④	Partition Set	Partition A	3
		Partition B	6
⑤	Grouped packaging label	1	

4-2 Individual Packaging

Box	Contents	Specification	Size (W x D x H)
C	TS+LCD, Accessories	Individual packaging (1units/box)	External dimension 371×271×114

※One box includes TS+LCD and accessories.

• Individual Packaging Configuration (C)

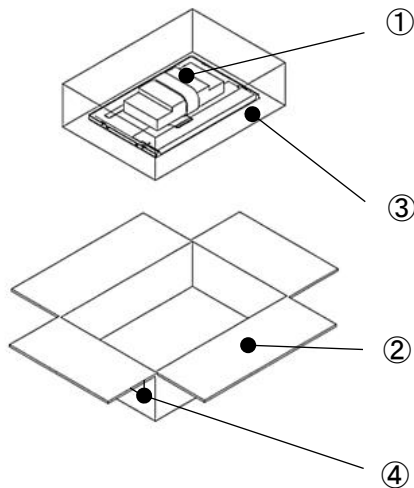

No.	Name	Qty
①	TS+LCD (placed inside antistatic bag) ※Touchscreen with protective sheet	1
	SWAD-A3 (placed inside air-cushion bag)	
	TSC-52/U (placed inside antistatic bag)	
	23E3E4-10003 (placed inside antistatic bag) 23E3E4-00005 (placed inside antistatic bag)	
②	Outer box	1
③	air cushion	-
④	packaging label	1

5 Module Specification

5-1 Function

Item		Specification	units	
LCD	Display device	12.1" Wide TFT LCD	-	
	Display area (Active area)	261.12(W) ×163.2(H)	mm	
	Pixels	1280(W) ×800(H)	-	
	Pixel pitch	0.204(W) ×0.204(H)	mm	
	Color	16.7M	colors	
	Brightness (Typ.)	310	cd/m ²	
	View angle (Typ.)	Vertical (Upper/Lower)	80 / 80	deg.
		Horizontal (Left/Right)	80 / 80	
	Interface	LVDS	-	
	Backlight method	LED, with backlight driver	-	
	Backlight life*1	Typ. 50,000	hours	
Touchscreen	Touchscreen type	Analog 4-wire resistive	-	
	Input method	Finger or R0.8 Polyacetal pen	-	
	Maximum simultaneous input point	1 point (supports gesture function)	-	
	Operating life	Continuous input (finger)	10,000,000	times
		Continuous input (pen)	100,000	characters
	Communication Method	USB 2.0	-	
Supporting OS	※2	-		
HDMI board	Input image port	HDMI (does not support HDCP)	-	
	Input Signal	Digital	HDMI 1.3b	-
		Horizontal scan cycle	30K - 80K	Hz
		Vertical scan cycle	50 - 60	Hz
Module	Bonding method	Air-bonding (Bonding of LCD and touchscreen with double-sided tape.)	-	
	Input power voltage*3	12±5%	V	
	Energy consumption(Max.)	14.5	W	

※1 Time until brightness declines by 50% from the initial value at maximum brightness in ambient temperature of 25°C.

※2 Please refer to the touchscreen controller OS compatibility table.

(<https://www.dush.co.jp/english/download/driver-app/>) (Target touchscreen controller: TSC-52)

※3 If the capacity of the power supply used is large, the drop in voltage when it is turned off will be gradual. When restarting, please turn on the power again after the power supply voltage becomes 0V.

5-2 Environment

Item	Specification
Ambient operating temperature (Inside cabinet and display side)	0°C to 55°C
Ambient storage temperature	-20°C to 70°C
Ambient operating humidity	10%RH to 85%RH (Non-condensing. Wet-bulb temperature is 39 °C or less)
Ambient storage humidity	10%RH to 85%RH (Non-condensing. Wet-bulb temperature is 39 °C or less)
Dust	0.1mg/m ³ or under (Conductive dust is prohibited)
Corrosive Gas	Corrosive gas is prohibited
Pollution Degree	Pollution Degree 2, for indoor use

5-3 Mechanical Specification

Item	Specification	
Mass	TS (Touchscreen) + LCD	Approx. 730 g
	Touchscreen controller	Approx. 8 g
	HDMI board	Approx. 50 g
	Cables	Approx. 5 g
External Measurements (TS (Touchscreen)) + LCD, excluding protruding parts)	279.56(W) × 184(H) × (12.26)(D) mm	

5-4 Touchscreen Controller

This is the Touchscreen controller with flick operation and 2-finger gesture (pinch-in/pinch-out and rotation)* functions.

For details, please refer to the downloadable document "Touch Screen Controller Specification : TSC-52/U User's Guide" in the table of contents.

※Two-finger touch input is a function to realize gesture operation, and position (coordinate) data at two-finger touch should not be used.

※When operating gestures, please keep a small distance between fingers.

5-5 Touchscreen Driver

In order to use the touchscreen, you will need to install a touchscreen driver (DMT-DD).

To obtain the driver, please download it from the following site.

URL: <https://www.dush.co.jp/english/download/driver-app/>

For DMT-DD installing directions, please refer to the User's Guide included in the downloaded files.

5-6 HDMI Board

5-6-1 Model

Model	Image Input Port
SWAD-A3	HDMI ×1

5-6-2 External Dimension

Item	Measurement
PCB outline (excluding connector)	110mm x 80 mm

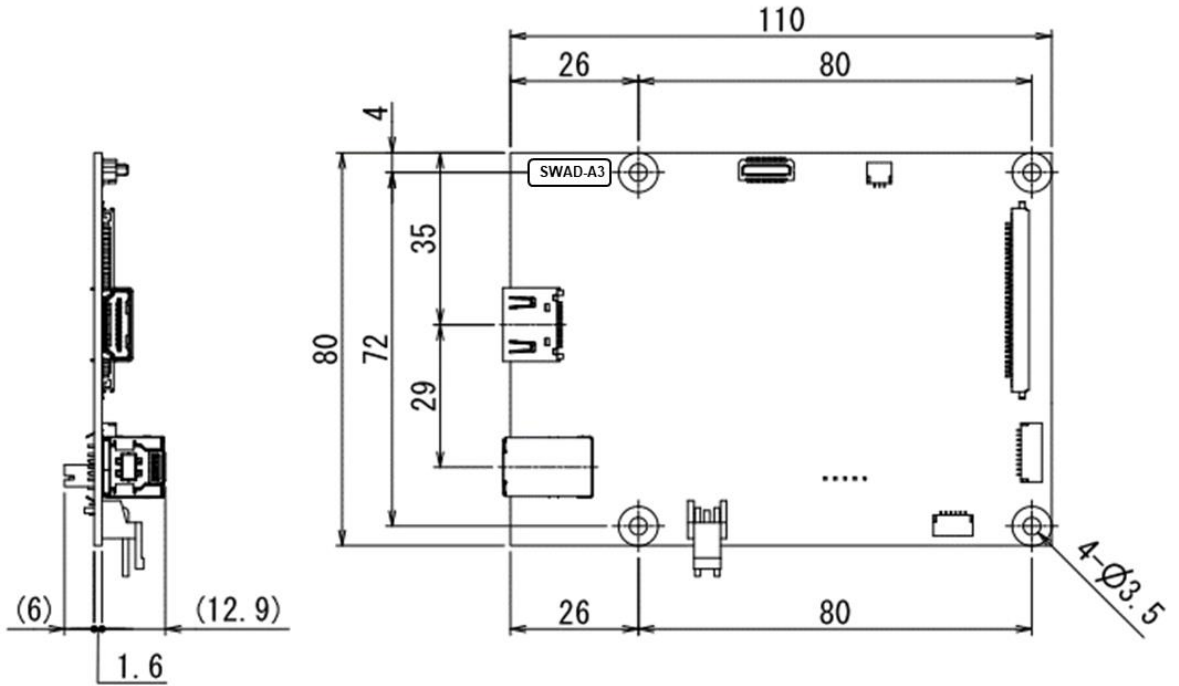

5-6-3 Support Timing

No	Resolution	Aspect Ratio	Refresh Rate
1	640×480p	4: 3	60Hz
2	720×480p	4: 3	60Hz
3	800×600p	4: 3	56Hz
4	800×600p	4: 3	60Hz
5	1024×768p	4: 3	60Hz
6	1280×720p	16: 9	60Hz
7	1280×960p	4: 3	60Hz
8	1280×1024p	5: 4	60Hz
9	1600×900p	16: 9	60Hz
10	1600×1200p	4: 3	60Hz
11	1680×1050p	16: 10	60Hz
12	1920×1080p	16: 9	60Hz

5-6-4 Part Names (HDMI Board)

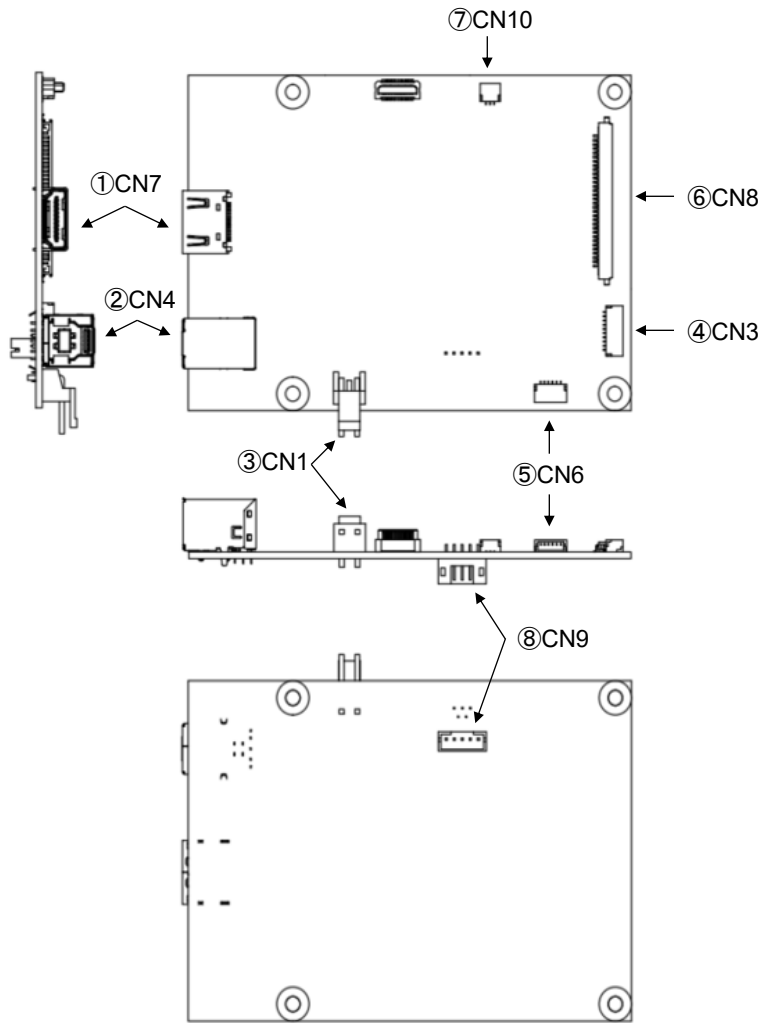

No.	Interface Name
①	Image input (HDMI)
②	Touchscreen control USB (USB 3.0 Type-B)
③	12VDC Power input (Nylon connector)
④	LCD Backlight control
⑤	Touchscreen controller connecting I/F ^{※1} (USB 2.0, Nylon connector)
⑥	LCD Image output (LVDS)
⑦	Pilot lamp LED control
⑧	OSD control I/F(Nylon connector)

※1 Connector for connecting the HDMI board and touchscreen controller.

※2 Use of other connectors not listed is prohibited. They are for internal adjustments only and may be excluded without prior notice.

5-6-5 Image Input (HDMI) I/F

Connector No.: CN7

Interface: HDMI Type A

※HDMI standard compliant

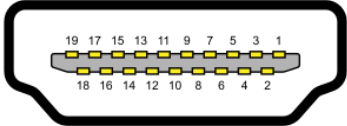
PIN No	Signal Name	PIN No	Signal Name	Schematic Diagram
1	TMDS Data2+	11	TMDS Clock Shield	
2	TMDS Data2 Shield	12	TMDS Clock-	
3	TMDS Data2-	13	CEC (NC)	
4	TMDS Data1+	14	Reserved	
5	TMDS Data1 Shield	15	DDC Clock	
6	TMDS Data1-	16	DDC Data	
7	TMDS Data0+	17	DDC GND	
8	TMDS Data0 Shield	18	+5V Power	
9	TMDS Data0-	19	Hot Plug Detect	
10	TMDS Clock+	-	-	

5-6-6 Touchscreen Control USB I/F

Connector No.: CN4

Interface: USB3.0

Connector: USB3.0 Type-B

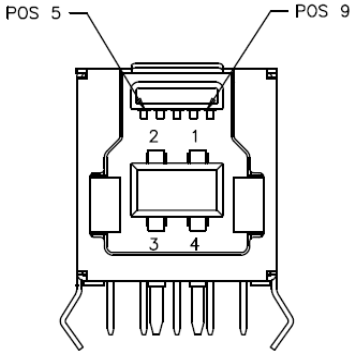
PIN No.	Signal Name	Description	Schematic Diagram
1	VBUS (5V)	Power	 <p>View from connector inserting side</p>
2	D-	USB 2.0	
3	D+		
4	GND	GND for power return	
5	StdB_SSTX-	SuperSpeed transmitter	
6	StdB_SSTX+		
7	GND_DRAIN	GND for signal return	
8	StdB_SSRX-	SuperSpeed receiver	
9	StdB_SSRX+		
10	Shield		

* USB port for touchscreen control (can be connected to USB2.0 Type-B).

5-6-7 12VDC Power Input I/F

Connector No.: CN1

Interface: +12VDC Input

Connector: A3963WR2-2P(JWT)

※Equivalent to S2P-VH(JST)

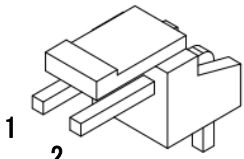
PIN No.	Signal Name	Schematic Diagram
1	+12V	
2	GND	

5-6-8 LCD Backlight Control I/F

Connector No.: CN3

Connector: 1010-SMTR-10P(JWT)

※Equivalent to SM10B-SRSS-TBT (JST)

PIN No.	Signal Name	Description
1	12V	Backlight power
2	12V	
3	12V	
4	12V	
5	GND	Ground
6	GND	
7	GND	
8	GND	
9	BL_EN	Backlight ON/OFF High level: Backlight ON. Low level: Backlight OFF.
10	BL_PWM	Backlight dimming input

※Specification (signal used) vary according to the connected LCD.

5-6-9 Touchscreen Controller Connection I/F

Connector No.: CN6

Interface: USB 2.0

Connector: 1010-SMTR-06P(JWT)

※Equivalent to SM06B-SRSS-TBT (JST)

PIN No.	Signal Name
1	VBUS
2	D-
3	D+
4	GND
5	RESETn
6	GND

※Specification (signal used) vary according to the connected touchscreen controller.

※Connector for connecting the HDMI board and the touchscreen controller.

5-6-10 LCD(LVDS) Output I/F

Connector No.: CN8

Interface: LVDS

Connector: 1058-HL-SMTR-30P(Well-in)

※Equivalent to FI-X30SSLA-HF (JAE)

PIN No.	Signal Name	PIN No.	Signal Name
1	O-Link0-	16	E-Link1+
2	O-Link0+	17	GND
3	O-Link1-	18	E-Link2-
4	O-Link1+	19	E-Link2+
5	O-Link2-	20	E-CLK-
6	O-Link2+	21	E-CLK+
7	GND	22	E-Link3-
8	O-CLK-	23	E-Link3+
9	O-CLK+	24	GND
10	O-Link3-	25	Panel VCC 3.3V
11	O-Link3+	26	Panel VCC 3.3V
12	E-Link0-	27	Panel VCC 3.3V
13	E-Link0+	28	Panel VCC 5V
14	GND	29	Panel VCC 5V
15	E-Link1-	30	Panel VCC 5V

※Specification (Signal used) vary according to the connected LCD.

5-6-11 Pilot Lamp LED Control I/F

Connector No.: CN10

Connector: 1010-SMTR-03P(JWT)

※Equivalent to SM03B-SRSS-TBT (JST)

PIN No.	Signal Name
1	LED_G
2	GND
3	LED_R

※Power supply 3.3V, limiting resistance 220Ω (board built-in)

5-6-12 Pilot Lamp LED

By preparing a LED board (refer to following circuit board diagram), the power of the HDMI board and the status of the image input signal can be indicated by LED.

▪ Status Indicating LED (Example)

Green lit: Power ON, with image input signal

Orange lit: Power ON, without image input signal.

LED off: Power OFF

▪ Circuit diagram (Example)

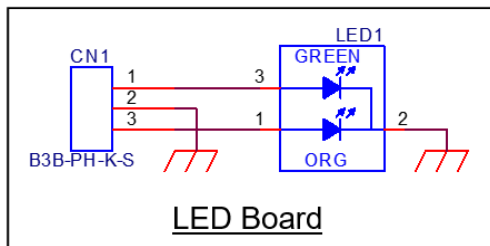

5-6-13 OSD Operation I/F

Connector No : CN9

Connector : 2000-WS-05P (JWT)

※Equivalent to B5B-PH-K-S (JST)

PIN No.	Signal Name	Description
1	MENU_ENTER	By connecting to GND, the OSD menu can be displayed, and the set status can be fixed (ENTER function).
2	DOWN	By connecting to GND, shift leftward in the selection of icons on the top menu, shift upward in the selection of items on the submenu, change parameter of each item, and decrease the value of bar meter of each item.
3	UP	By connecting to GND, shift rightward in the selection of icons on the top menu, shift downward in the selection of items on the submenus, change parameter of each item, and increase the value of bar meter of each item.
4	GND	Ground
5	POWER_LCD ※1 ※2	By connecting to GND, turned ON/OFF the power of LCD.

※1 For continuous ON/OFF operation, please allow an interval of at least 5 seconds.

※2 The status is maintained even when the power to the HDMI board is turned on and off.

5-6-14 OSD Operation Switch Reference Circuit

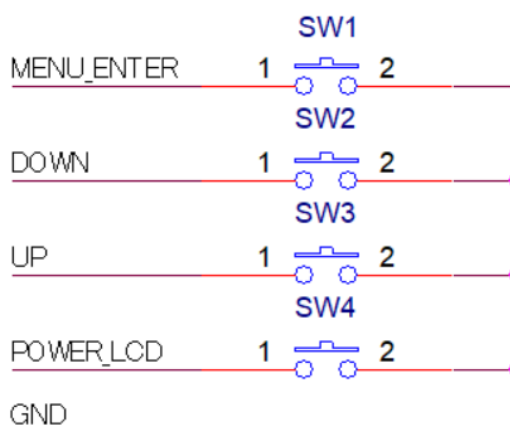

6 Product Label

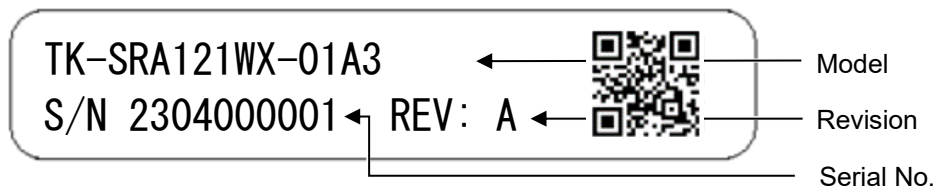

Above is an image example of the product label.

Below information will be indicated on the actual product.

- Model: Product Model
- Serial No.: 10 digit control number
- Revision: Alphabets (A to Z) according to the product revision

7 Compliant Standards

7-1 RoHS

Compliant to EU RoHS directives.

8 Appearance inspection standard

Please refer to “Appearance inspection standard(LCD Modules with Resistive Touchscreen)” (22G4GX-00001E) for standards.

9 Connecting Method

9-1 Connecting Diagram

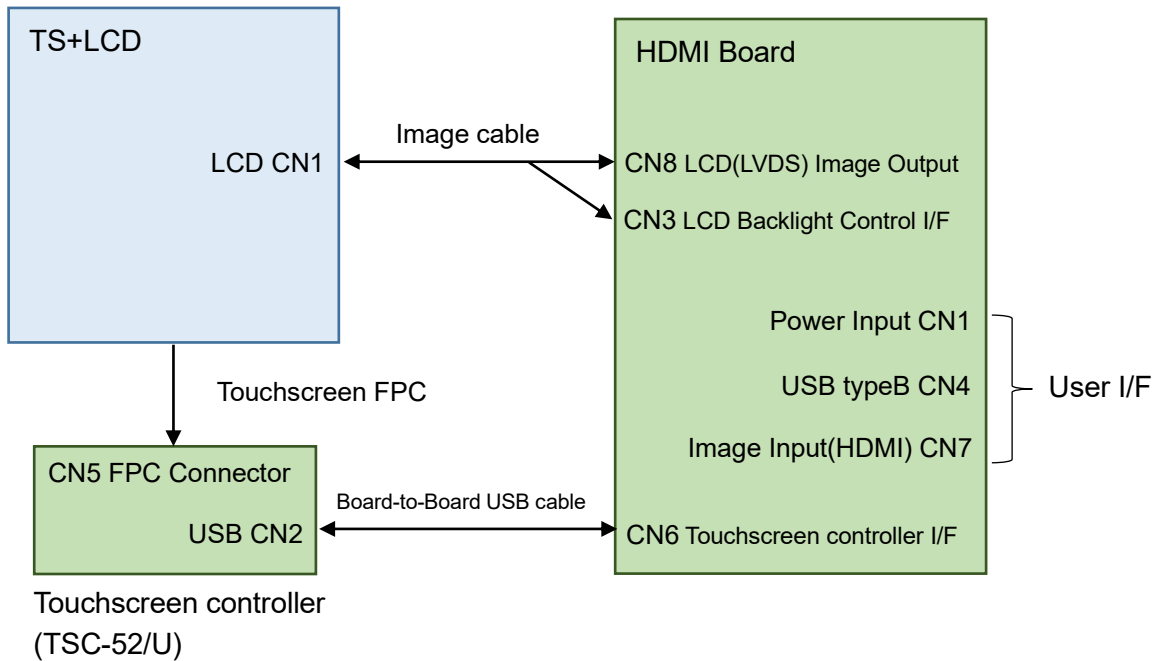

9-2 Connecting Image Cable to LCD

- (1) Slide the housing of the image cable into the connector on the backside of the LCD in the direction shown below.

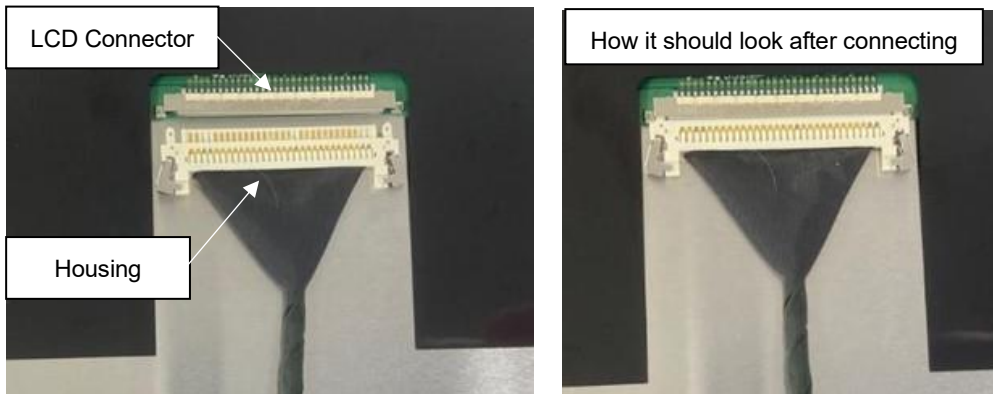

9-3 Connecting Touchscreen FPC to Touchscreen Controller

- (1) Insert securely into the connector of the touchscreen controller in the direction with the touchscreen FPC visible.

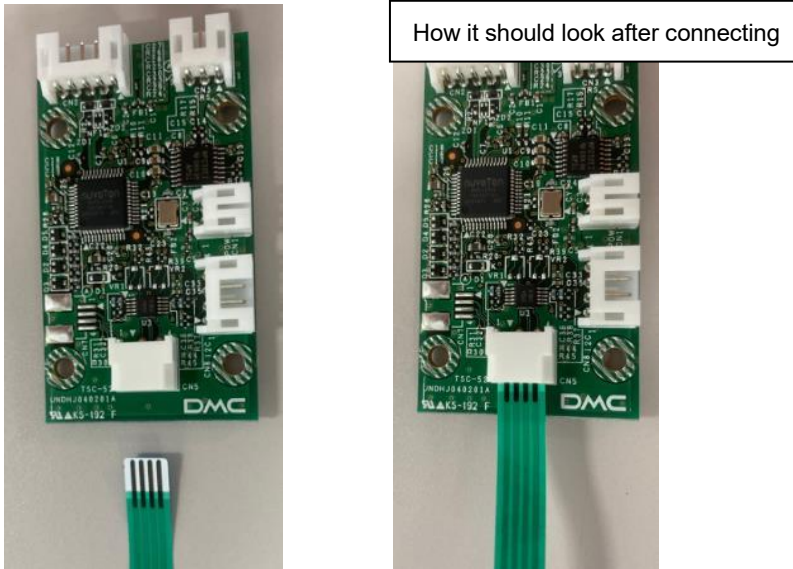

9-4 Connecting Image Cable to HDMI Board

- (1) Insert the image cable securely into the connector in the two locations of the HDMI board.

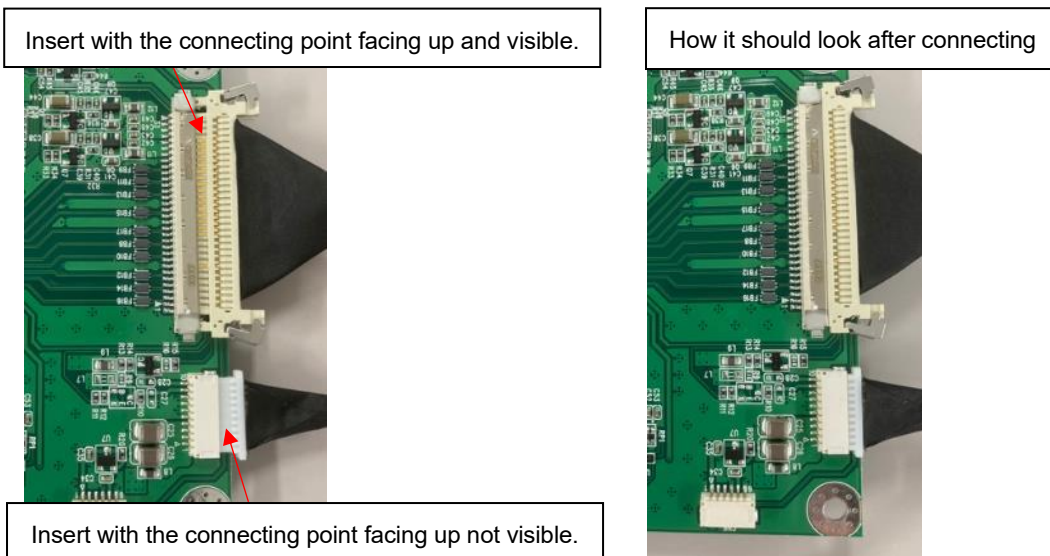

9-5 Connecting Board-to-Board USB Cable to HDMI Board

- (1) Insert the board-to-board USB cable securely into the connector of the HDMI board as shown in below diagram.

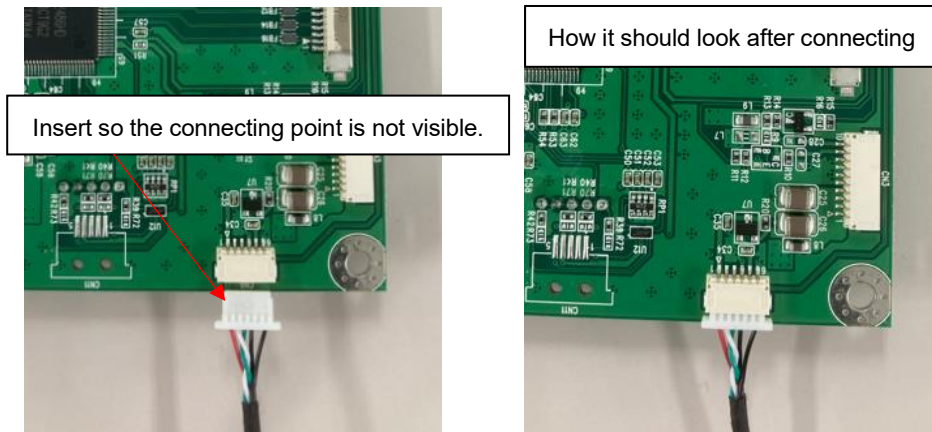

9-6 Connecting Board-to-Board USB Cable to Touchscreen Controller

- (1) Insert the board-to-board USB cable securely into the connector of the touchscreen controller as shown in below diagram.

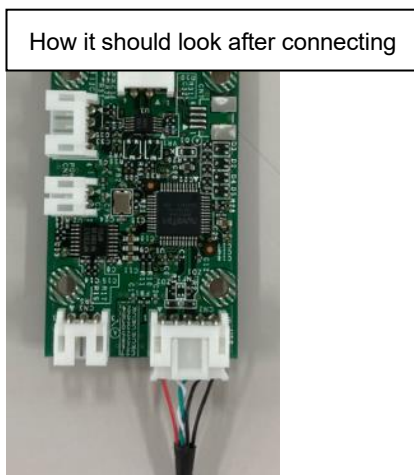

9-7 Connecting Each Cable to User I/F of HDMI Board

(1) Connecting the HDMI cable and the USB cable.

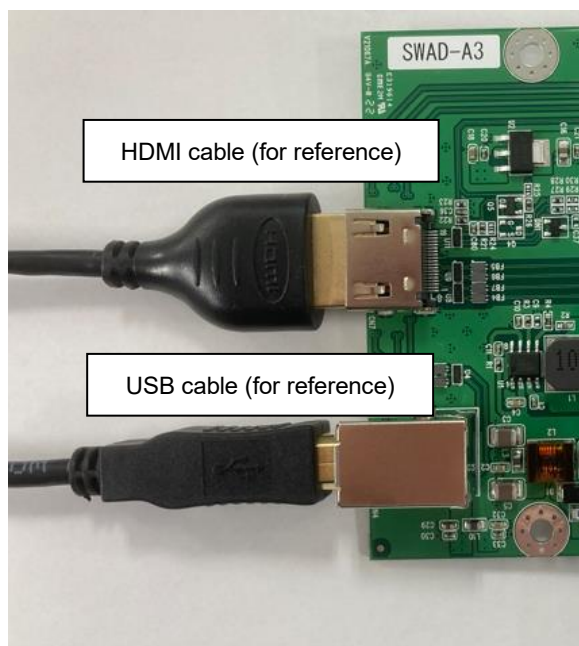

※Please insert securely.

※HDMI cable/ USB cable not included.

(2) Connecting the Power cable.

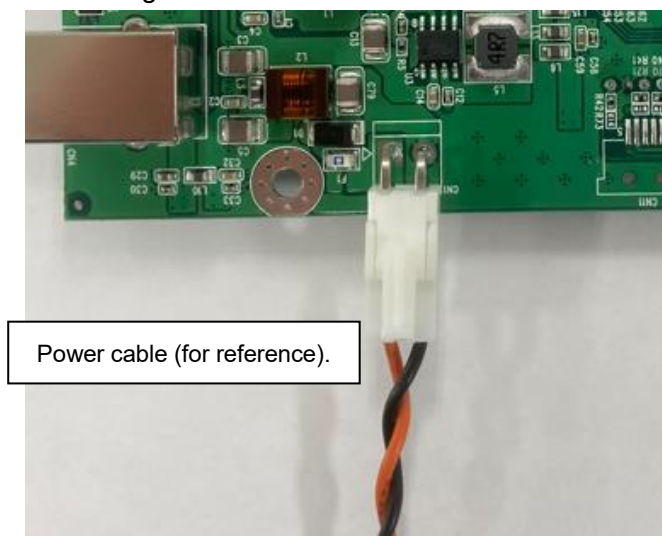

※Please insert securely.

※Power cable not included.

10 Touchscreen Calibration

Touchscreen operations may become unstable depending on the installation environment due to its characteristics. To use it correctly, please perform calibration when building into a device.

Install DMT-DD from "[5-5. Touchscreen Driver](#)" when calibrating.

10-1 Resistive Touchscreen

[4-point correction] or [9 point correction] ...Coordinate calibration.

- (1) Start DMT-DD.
- (2) Choose the [Software Setting] tab via [Basic Setting]

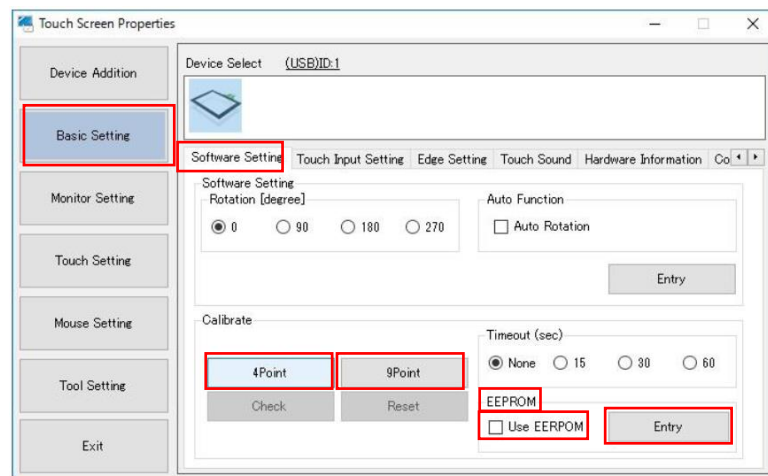

- (3) Click and place a check in the box next to [Use] under [EEPROM] and click [Register].
When [4 Point Correction] or [9 Point Correction] is performed with the check in the box, the correction data will be stored in the EEPROM of the Product.
When performed without the check, then the correction data will be stored inside the computer.
[4 Point Correction] is conducted to the Product at shipment from the factory and the correction data is stored in the EEPROM.
Placing the check will recall the data from the EEPROM and correction will not be necessary.
If touch coordinates are out of alignment, please follow the procedure below and perform coordinate calibration.
When correction is performed without placing the check, the correction data at factory shipment will not be reflected and accurate touch operation may not be possible.

- (4) Below adjustment screen will be displayed when [4 point correction] or [9 point correction] is clicked.

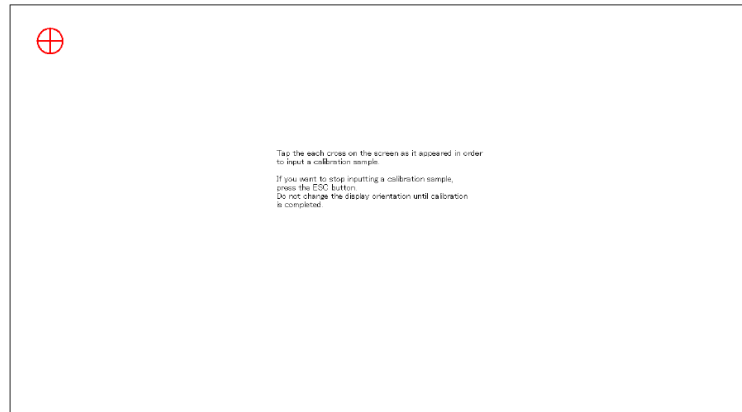

- (5) Touch the center of the marker displayed on the screen. Another marker will be displayed one after another. Do the same for all.
- (6) After all markers have been touched, adjustment is completed and the following screen will be displayed.

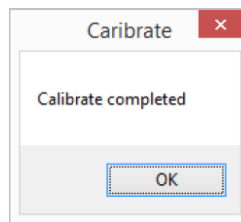

- (7) Click [OK] to finish the adjustment.

10-2 Gesture Correction (DO NOT PERFORM)

Gesture correction is performed at the factory before shipment and does not need to be performed.

If gesture correction is performed, touch operation may not work properly.

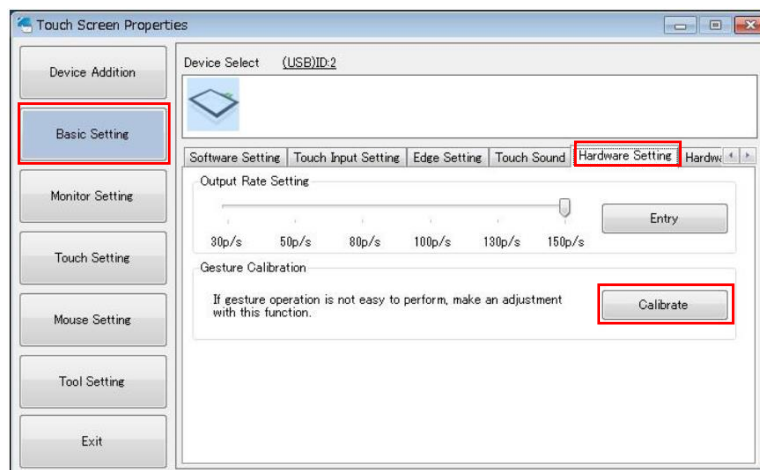

11 OSD Function

Various configurations and adjustments can be made with the OSD (On Screen Display).



The OSD can be operated using the “MENU_ENTER” control and “UP” / “DOWN” control described in section “[5-6-13 OSD Operation I/F \(CN9\)](#)”.





The value set once will be retained and will not be deleted when power is shut down.

11-1 OSD Menu

Top menu icons

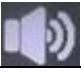
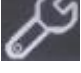

Main Menu	Submenu	Adjustment range	Initial Value	Description	
PICTURE 	Brightness	0 ~ 100	100	Adjust brightness of display	
	Contrast	0 ~ 100	50	Adjust contrast of display	
	Sharpness	0 ~ 4	2	Adjust sharpness of display	
	Exit	-	-	Go back to main menu	
DISPLAY 	Auto Adjustment	N/A (Analog RGB input operation is possible)			
	H Position	0 ~ 100	50	Adjust horizontal position of display.	
	V Position	0 ~ 100	-	Adjust vertical position of display	
	Pixel Clock	N/A (Analog RGB input operation is possible)			
	Phase	N/A (Analog RGB input operation is possible)			
	Exit	-	-	Go back to main menu	
COLOR 	Gamma	OFF 1.8 2.2 2.4	OFF	Adjust Gamma value	
	Color Temp	5800K 6500K 7500K 9300K sRGB	User	Adjust color temperature ※The color temperatures (5800K to sRGB) are not adjusted. Please change the RGB in the User settings to adjust.	
		User			R : G : B individually: 0 ~ 255 default value R:128, G:128, B:128
	Color Effect	Standard Dynamic Movie Photo Vivid	Standard	Adjust color effect	
		User		R : Y : G : C : B : M individually: 0 ~ 100	
	Auto Color	N/A (Analog RGB input operation is possible)			
	Exit	-	-	-	Go back to main menu

ADVANCE 	Aspect Ratio	Full 16:9 4:3 5:4 Original	Full	Adjust aspect ratio
	Exit	-	-	Go back to main menu
INPUT 	N/A (Only HDMI)			
AUDIO 	N/A			
OTHER 	Reset	-	-	Reset to initial value
	Menu Time	0 ~ 30	10	Set time display of OSD menu
	OSD H Position	0 ~ 100	50	Adjust horizontal position of OSD menu
	OSD V Position	0 ~ 100	50	Adjust vertical position of OSD menu
	Transparency	0 ~ 7	0	Adjust transparency of OSD menu
	Exit	-	-	Go back to main menu
INFOMATION (EXIT) 	-	-	-	Exit OSD

11-2 OSD Menu Operation

11-2-1 System Configuration

Displaying the OSD

- (1) Press "MENU_ENTER" switch to display the main menu of the OSD.

Selecting with the OSD

- (1) Choose the icon on the OSD main menu by pressing "UP" / "DOWN" switch while OSD is displayed.
The icon in yellow is the icon in the selected state.
- (2) Press "MENU_ENTER" switch to choose icon.
- (3) Choose the item on the OSD sub menu by pressing "UP" / "DOWN" switch while OSD is displayed.
The item in white is the item in the selected state.
- (4) Press "UP" / "DOWN" switch to change the value of "Bar Meter" and "Parameter", and press "MENU_ENTER" switch to set.
 - ※ The set value will be retained in the Scaler Board. It will not change even after the power is turned OFF.

Exiting the OSD

- (1) After making the adjustments, select [EXIT] of the sub menu to go back to the main menu.
 - (2) Select [INFORMATION] of the main menu to end the OSD.
 - ※ If an operation is aborted, the OSD will automatically close at the auto close Time (Menu Time).
- Refer to "[11-2-4 Setting Auto close Time \(Menu Time\) of OSD Menu](#)" for details on how to set the OSD Timer.

11-2-2 Adjusting Brightness

- (1) Open the OSD menu.
- (2) Select [PICTURE] (main menu icon) > [Brightness] (submenu item).
- (3) Adjust the bar meter of [Brightness], brightness of the LCD can be changed in real time.
- (4) Set your preferable brightness.
- (5) End the OSD menu.

11-2-3 Changing Color Temperature

- (1) Open the OSD menu.
 - (2) Select [COLOR] (main menu icon) > [Color Temp] (submenu item).
 - (3) Set your preferable color temperature.
 - (4) Select [User] ,individual colors "R"(Red),"G"(Green),"B"(Blue) can be adjusted.
 - (5) End the OSD menu.
- ※Depending on the LCD you prepared, it may not be possible to set the color temperature correctly.

11-2-4 Setting Auto Close Time (Menu Time) of OSD Menu

Set the auto close time (Menu Time) to automatically close the OSD menu.

The Auto close time of the OSD menu can be set 0 ~ 30 seconds.

Set the value "0", the OSD menu will not be closed.

Please note that even if the value is not set ("MENU_ENTER" switch is not pressed), the value you lastly adjusted will be set when the timing of the OSD menu close.

- (1) Open the OSD menu.
- (2) Select [OTHER] (main menu icon) > [Menu Time] (submenu item).
- (3) Press "UP" / "DOWN" switch, change the value (0 ~ 30s) of the "Bar Meter".
- (4) Set your preferable auto close time.
- (5) End the OSD menu.

11-2-5 Return to Initial Values

Return the values of the OSD to the initial state.

- (1) Open the OSD menu.
- (2) Select [OTHER] (main menu icon) > [Reset] (submenu item).

12 Terms of Use

12-1 Installing Resistive Touchscreen

(1) When opening the entire surface of the touchscreen and applying sheet to the surface

- Design and adjust the touchscreen surface slightly offset from the sheet surface (about 0.3mm recommended) in order to avoid the sheet surface from pressing on the touchscreen.
- To avoid damage to the LCD (Liquid crystal display) and FPC tail of the touchscreen, make sure they do not come in direct contact with the edge of the panel openings. If damaged, display and touchscreen may not operate properly.

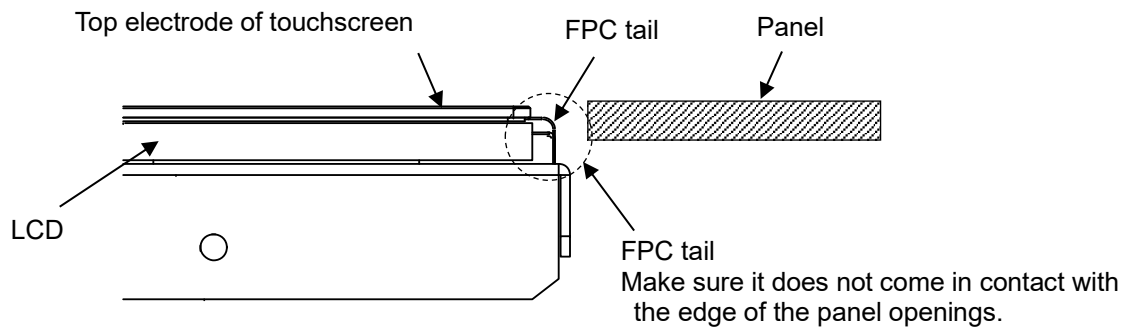

(2) If Bezel Come on Top of Touchscreen Surface

- Be sure to keep a clearance of 0.5 mm or more between the inside of the bezel and the upper electrode of the touchscreen to avoid input errors caused by strains of the bezel when hands are placed on it.
- When placing cushions between the inside of the bezel and the upper electrode of the touchscreen, be sure to have some allowance to absorb the expansion/contraction differences between them due to temperature change. If the cushion is pressed down strongly, it may not be able to absorb the expansion/contraction and may cause distortion or deflection of the electrode which may affect both appearance and function. The cushioning material must be installed 1.0 mm or more outward from the edge of the insulation area.

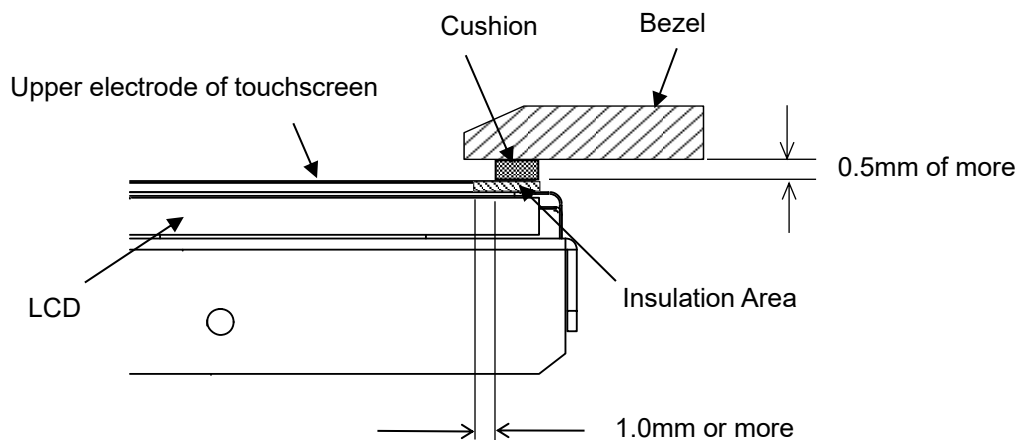

12-2 Installing Module

- (1) For stable brightness and display, connect the GND via the mounting hole on the LCD.
- (2) Mount the LSI so that no external pressure is applied to the LSI mounting area.
- (3) Make sure there are no warping and twisting when installing.
- (4) Make sure the specified temperature and humidity between the module and structure or parts is taken into consideration to secure ventilation.
- (5) Take anti-static measures such as wearing grounding arm bands during assembly.
- (6) To prevent malfunction or damage, please insert each cable and touchscreen FPCs completely and securely to the connector.
- (7) Remove the protection sheet on the touchscreen when installing.
- (8) Be sure to fix the LCD when mounting the module to a chassis. Since the LCD and the touchscreen are attached with double-sided tape, the LCD may fall off if only the touchscreen side is fixed.

12-3 Precautions for Use of LCD

- (1) The LCD contains irritants inside. If by any chance the liquid should flow out due to damages and come in contact with the skin, wash immediately under running water for more than 15 minutes and consult a physician.
- (2) LCD may have uneven brightness depending on the contents displayed. Please note that this is not a malfunction.
- (3) LCD elements may have spots (black spots/ bright spots). This is a characteristic of the LCD and not a malfunction.
- (4) When screen is viewed outside the viewing angle, the color displayed may appear to change. This is a basic characteristic of the LCD and not a malfunction.
- (5) When the same screen is displayed for a certain long period of time, the image may remain as an afterimage. This is a basic characteristic of the LCD.
In order to avoid afterimages, use a screensaver or other similar functions to periodically change the display and avoid displaying the same image for a long period of time.

12-4 Precautions for Resistive Touchscreen

- (1) Applications that require to press the same point on the touchscreen for a long time may cause malfunction due to the structure of the touchscreen.
The touchscreen is made of glass. Glass is easily damaged when scratched.
Please handle the touchscreen so that glass does not come in contact with other glass or hard objects.
- (2) The touchscreen is made of glass. Glass can easily break if scratched.
Please handle the touchscreen so that glass does not come in contact with other glass or hard objects.
- (3) Due to the characteristics of the touchscreen, area slightly outside the display area may be detected as the coordinates of the edge of the touchscreen. Please design your application with this in mind.
- (4) The coordinates of the touchscreen may shift over time or depending on the environment in which it is used. If the touchscreen coordinates get misaligned, please conduct calibration for coordinate correction.
- (5) Handle the edge of the glass with care as it may cause injuries.

12-5 Precautions for Static Electricity

- (1) Static Electricity may cause damages. Please take sufficient measurements when handling.
- (2) Any personal handling the product should take measurements. Wearing grounding bands is recommended.

12-6 Operating Precautions

- (1) When used outside the specification standards, it may significantly affect product quality and service life, such as degradation of display quality and generation of air bubbles. Please be sure to use within the specifications.

12-7 Storing Precautions

- (1) When storing the module, please avoid areas of high temperature and humidity. Especially when storing for a long period of time, make sure to store in a place that is not be exposed to direct sunlight and/or fluorescent lighting.
- (2) Please store the module in a condition where it is not subject to excessive load.

12-8 Handling Precautions

- (1) Do not leave the product in an environment with high temperature for a prolong period. Make sure to avoid high humidity especially when the temperature is above 40°C. Failing to do so may cause polarizing plate deterioration, peeling, and/or bubbles to form.
- (2) If the surface of the polarizing plate becomes dirty, wipe it lightly with a soft material such as cotton cloth moistened with a small amount of ethyl alcohol.
- (3) Make sure to wipe off immediately any form of liquids to avoid deformation, discoloration or fading of the polarizing plate.
- (4) Condensation on the polarizing plate during testing is prohibited to prevent staining, discoloration, or spots to form on the plate.
- (5) Disassembling and/or changing the volume of the module is prohibited. Doing so may cause malfunction and failure to perform correctly.
- (6) This product is intended for use in general electronic equipment and is not intended for use in special environments such as corrosive gas atmosphere. If use in a special environment is anticipated, please evaluate the product thoroughly or take precautions not to expose the LCD to corrosive gases, etc.
- (7) This product is intended for use in standard applications (office equipment, industrial, communication, and household equipment, etc.). Do not use the products for special applications that require extremely high reliability (e.g., aerospace, nuclear power control, medical applications for life support, etc.) or where malfunctions or failures may directly cause injuries to the human body.
- (8) Do not rub or press the product with hard or sharp objects.
- (9) Keep away from flames/fire.
- (10) Avoid wiping the product with excessive pressure.
- (11) Avoid locally rubbing the product with strong pressure. It may cause damage to the function of the touchscreen.
- (12) When operating the product, please avoid striking it with a hard object.
- (13) Do not forcibly fold or bend the product.

- (14) When storing the product, use the packing box and keep the product within the specified storage temperature and humidity and in an environment where it is free of excessive pressure and loads.
- (15) Avoid using and storing the product where it can be exposed to or can come in contact with liquids, organic solvents, and acidic atmosphere.
- (16) Avoid using the product in direct sunlight.
- (17) Do not pull off or disassemble the product.
- (18) When handling the product, hold the main unit and not the touchscreen FPC (tail).
- (19) EMC (EMS, EMI) evaluation is not conducted at shipment. Please conduct overall evaluation and confirmation after the product has been installed in your equipment.

13 Warranty

The warranty period is limited to 12 months (1 year) from the date of shipment. Any defects that occur upon normal use under conditions specified herein will be repaired (factory repair) free of charge. (Warranty for any repair needed to the same repaired part of the same product is three months.)

You will be liable for all repair fees even within the warranty period for any conditions listed below.

- (1) Any malfunctions, defects, and/or damages that occurred during transport, transfer, or mishandling by the user after delivery.
- (2) Any malfunctions, defects, and/or damages caused by natural or man-made disaster.
- (3) If the product is used under any condition, environment, or method other than those specified in the specifications, catalogs, manuals, notes, and/or other documents.
- (4) Any malfunctions, defects, and/or damages caused by connected equipment and/or usage of inappropriate consumables and media.
- (5) If the product is repaired, remodeled, modified, or disassembled by a party other than DMC Co., Ltd, or if a serial number label cannot be verified.
- (6) Any failure, damage, or malfunction is deemed to be caused on your behalf.

This warranty covers only the product itself. Any damages, on-site repairs and replacement driven by the failure of the product will be decided upon discussion by both parties as necessary. This product is structurally not repairable. All damaged parts are subject for replacement and freight will be charged.

14 Production Discontinuance

In the event of production discontinuance, an announcement will be made six months prior to the last possible order reception date.

15 Other

For comments or queries, feel free to contact us.

North South America area

technical-global@dush.co.jp

Asia Pacific area

technical-global-asia@dush.co.jp

Europe, Middle East, Africa area

technical-global-eu@dush.co.jp

FAQ

<https://www.dush.co.jp/english/support/faq/>

5th Edition, October 2024

DMC Co., Ltd.

Business hours: 9:00a.m.to 5:00p.m. (JST)

URL: <https://www.dush.co.jp/english/>

This document is protected by copyright law. Photocopying, duplicating, reproducing, and modifying of this product or document in part or by whole is prohibited.

Copyright(C) 2024 DMC Co., Ltd. All Rights Reserved

SYM	改訂日 DATE	改訂内容 DESCRIPTION	ページ PAGE	担当 DESIGNED
	2023.05.23	新規図面登録	-	S. Takada

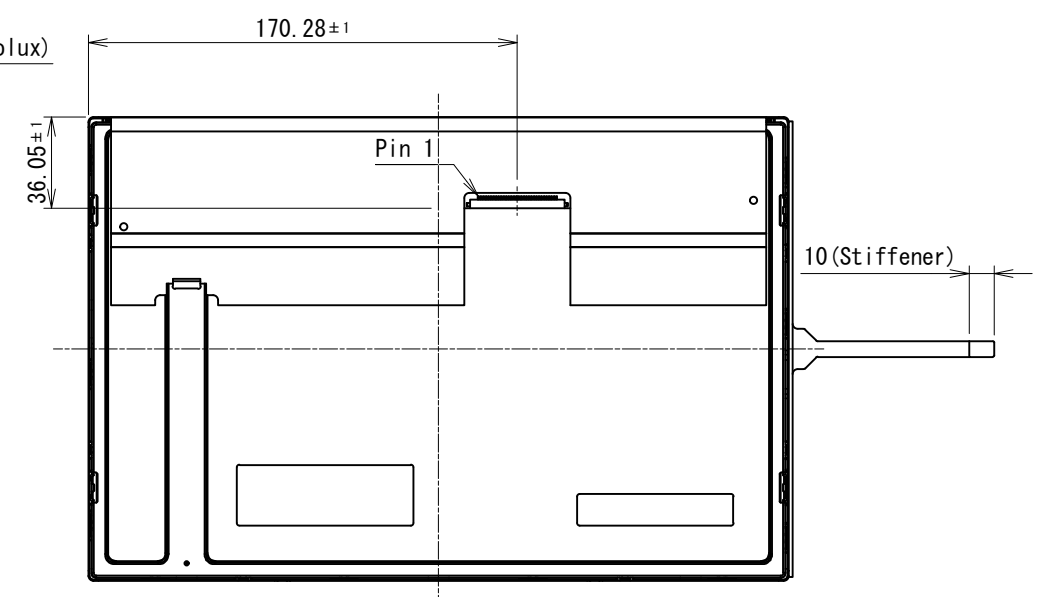
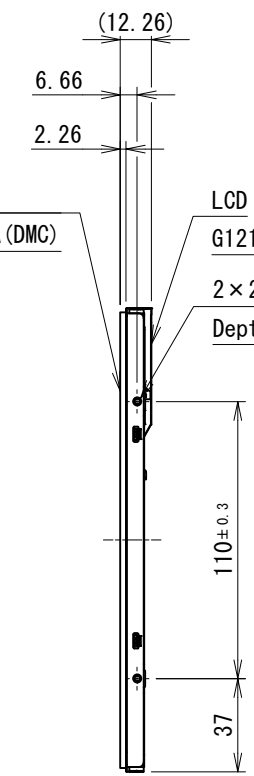
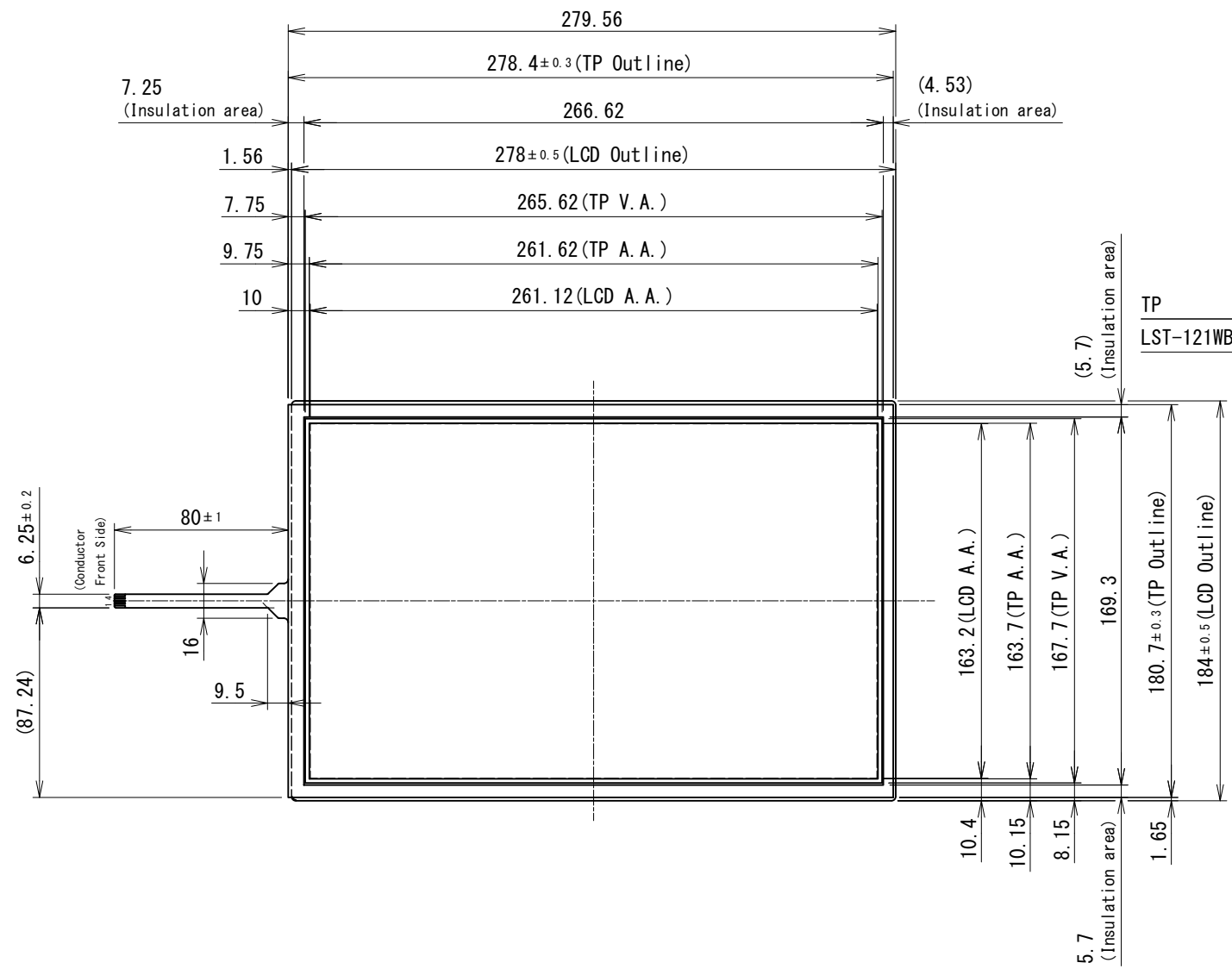

- NOTES
1. タッチ方式：抵抗膜方式
Type : Resistive Touchscreen
 2. ITOガラス：厚さ1.8mm
ITO Glass : thickness 1.8mm
 3. LCD Connector : P2 187114-30091 (P-Two)
 4. 指示無き寸法公差は、±0.5mmとする。
Tolerance shall be of ±0.5mm Unless specified otherwise.

製図日 ISSUED	2023.05.23	部署 SECTION	Technical Dept.	尺度 SCALE	CAD登録名 CAD FILE NAME	OUTLINE_TK-SRA121WX-01A3	RoHS対応品 RoHS compliant
承認 APPROVED		検図 CHECKED		1:3	製品名 MODEL	TK-SRA121WX-01A3	
		製図 DRAWN	S. Takada	単位 UNIT	図名 TITLE	OUTLINE	ページ PAGE
T. Okada	S. Yoshimoto		S. Takada	mm			1 / 1
DMC Co., Ltd.			A3	図番 DWG No.	SM3-002393-10		

Appearance Inspection Standard (1)

1.1 Inspection condition

Inspection Distance : 35 ± 5 cm

View Angle : Inspection under non-operating condition : $\pm 30^\circ$

Ambient Illumination : 500~2000 lux

Inspection time : 3~5 seconds

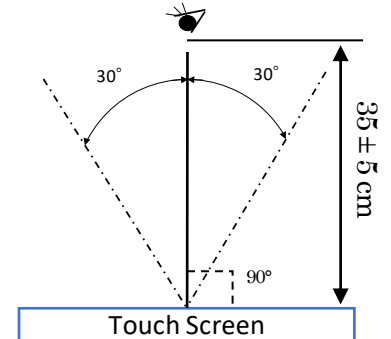

1.2 Scratch, dust (W = width, L = length, D = average diameter = (longest + shortest) / 2))

Total defects on each panel.

- 【 14 inches < Size \leq 22 inches 】 Within 10 pcs / panel
- 【 10 inches < Size \leq 14 inches 】 Within 7 pcs / panel
- 【 Size \leq 10 inches 】 Within 5 pcs / panel

Item	Width(mm)	Length(mm)	Acceptable Numbers
Linear(Scratch/Dust) Over 0.1mm in diameter refer to the Circular.	$0.05 < W \leq 0.1$	$L \leq 4$	1pcs in $\phi 30$ mm
	$0.03 < W \leq 0.05$	$L \leq 10$	2pcs in $\phi 20$ mm
	$W \leq 0.03$	$L \leq 20$	Acceptable
Circular(Scratch/Dust)	$0.3 < D \leq 0.4$		1pcs in viewing area *1
	$0.2 < D \leq 0.3$		2pcs in $\phi 30$ mm
	$D \leq 0.2$		Acceptable

Applied only in the Viewing Area.

Scratches or dusts in the outside of the Viewing Area are acceptable unless the electrical characteristics are affected.

*1 Applied to 14 inches or larger panel.

- Acceptable if not noticeable on a black mat.

Product	LCD Modules with Resistive Touchscreen	Document No.	22G4GX-00001E-0
---------	--	--------------	-----------------

Appearance Inspection Standard (2)

1.3 Chip, crack (t = glass thickness) (applicable only for the glass)

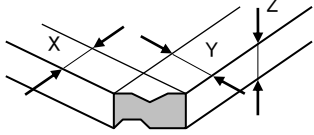
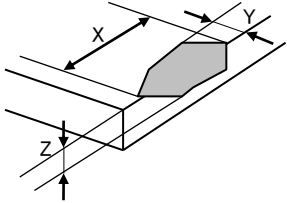
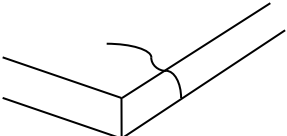
Item	Size(mm)		Acceptable Numbers
Corner		X ≤ 3	2pcs /panel
		Y ≤ 3	
		Z $\leq t$	
Side		X ≤ 5	2 pcs /on one side
		Y ≤ 3	
		Z $\leq t$	
Crack			Not acceptable